

# Public Spaces

## Government | Institutional

Accommodating large areas—and large crowds—beautifully

From airports to entertainment facilities, these tile installations are under constant stress from routine foot and wheeled traffic. While durability is essential, it's also important that large expanses of tile be uniform in appearance and maintain their aesthetic appeal.



### LevelQuik® RS

**LevelQuik® RS**, a rapid-setting self-leveling underlayment, can be poured up to 1-1/2 inches deep and is walkable in as little as 4 hours. Fast-track installations and projects that require an extra-heavy rating for high impact are ideal for **LevelQuik® RS**.



#### Common Concerns

- Appearance is key
- Large-format tile
- Limited downtime
- Heavy foot traffic, and rolling loads

#### Installation Solutions

Self-Leveling Underlayment	<b>LevelQuik® RS</b>
Waterproofing Membrane	<b>RedGard® Liquid</b>
Crack Isolation Membrane	<b>Crack Buster® Pro, RedGard® Liquid</b>
Mortar	<b>MegaLite® RS, ProLite® RS</b>
Grout	<b>Prism®, Fusion Pro®</b>
Movement Joint Treatment	<b>Commercial 100% Silicone Sealant</b>
Maintenance	<b>Aqua Mix® Sealers &amp; Cleaners</b>

#### Reference Projects

**United States Courthouse,**  
Los Angeles, CA

**University of Michigan,**  
Ann Arbor, MI

**Diablo Valley College,**  
Pleasant Hill, CA

**State Dept. of Information Systems,**  
Olympia, WA

**James Enochs High School,**  
Modesto, CA

**Michigan Technological University,**  
Houghton, MI

**Pierce College,**  
Los Angeles, CA

**University of Wyoming,**  
Laramie, WY

**Inland Regional Center,**  
San Bernardino, CA

**University of Utah School of Dentistry,**  
Salt Lake City, UT

**New Trier High School,**  
Winnetka, IL

**California State University,**  
Northridge, CA

**National Institute of Standards and Technology,**  
Boulder, CO

**North Atlanta High School,**  
Atlanta, GA

**Duval County Courthouse,**  
Jacksonville, FL

**Church of Latter Day Saints,**  
Worldwide

**Aventura Chabad,**  
Aventura, FL

**Christ Cathedral,**  
Garden Grove, CA

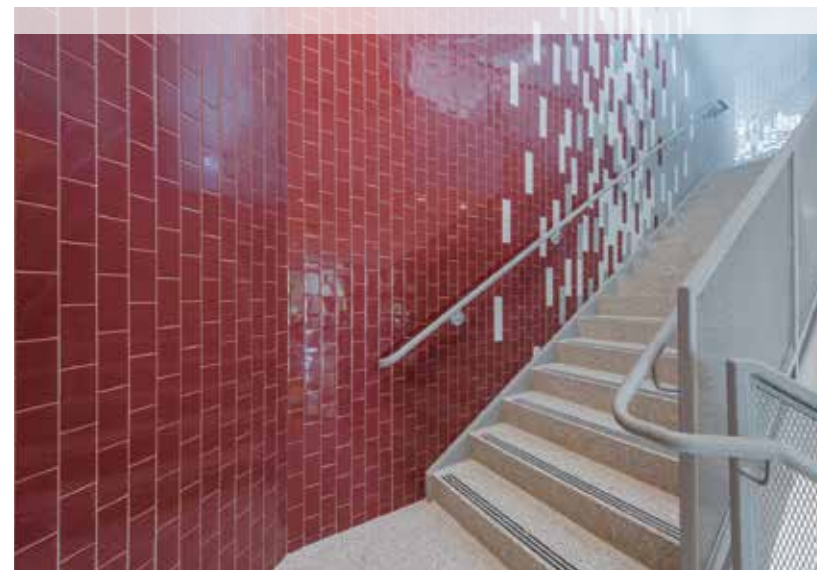
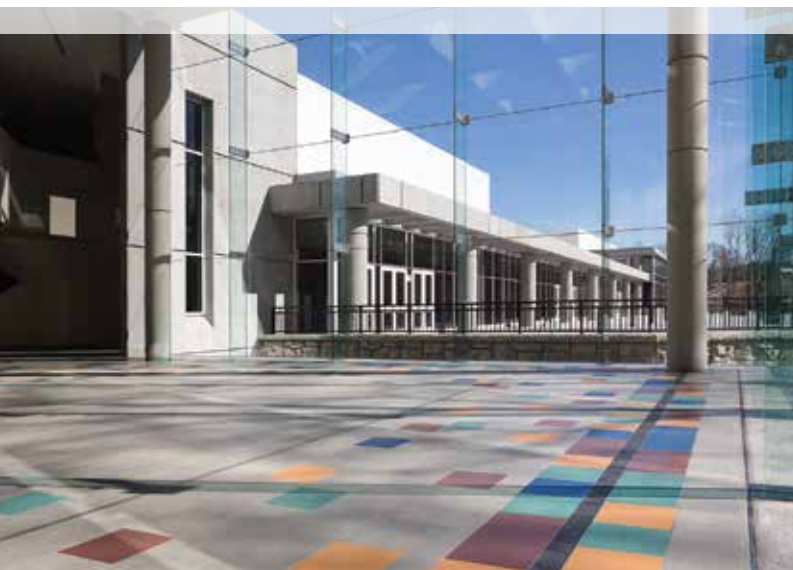



# Public Spaces

Commercial | Corporate

Function and Beauty

From airports to entertainment facilities, these tile installations are under constant stress from routine foot and wheeled traffic. While durability is essential, it's also important that large expanses of tile be uniform in appearance and maintain their aesthetic appeal.



## ProLite®

**ProLite® Premium Large Format Tile Mortar** offers high bond strength in a versatile formula for setting everything from glass to large format tile. Ideal for vertical applications, ProLite also offers non-slip performance for floor installations. Formulated with CustomLite Technology and recycled content, ProLite contributes to LEED certification.



### Reference Projects

**Apple Park,**  
Cupertino, CA

**Amazon Global Headquarters,**  
Seattle, WA

**Samsung America Headquarters,**  
San Jose, CA

**Burj Khalifa Tower,**  
Dubai, U.A.E.

**Honda Motors Showroom,**  
San Francisco, CA

**Kentucky Convention Center,** Louisville, KY

**Brocade Communications Headquarters,**  
San Jose, CA

**Les Schwab Tire Centers,** Nationwide

**The Campus at Playa Vista,** Los Angeles, CA

**Hyundai America Headquarters,**  
Fountain Valley, CA

**Cadillac Fairview,**  
Calgary, AB

**Genentech B40 Campus,**  
So. San Francisco, CA

**Exxon Corporate Offices,** Irving, TX

**PIMCO Global Headquarters,**  
Newport Beach, CA

**Township 14 Business Park,** San Diego, CA

**Ferrari Dealership,**  
San Antonio, TX

**Monsanto Calgene Research,**  
Woodland, CA

**Amazon Distribution Center,**  
Moreno Valley, CA



# Public Spaces

Transportation | Entertainment

Open—Accessible—Inviting

From airports to entertainment facilities, these tile installations are under constant stress from routine foot and wheeled traffic. While durability is essential, it's also important that large expanses of tile be uniform in appearance and maintain their aesthetic appeal.



## Prism®

**Prism® Ultimate Performance Cement Grout** is simply the best high-performance cement grout on the market. Period. With its unique formula Prism offers consistent color without shading, regardless of tile type, temperature or humidity. Prism is also highly stain resistant making this a superb choice for spaces that endure heavy traffic.



### Reference Projects

- |  |   |
|--|---|
| <b>Los Angeles International Airport,</b><br>Los Angeles, CA               | <b>Levi's Stadium, Santa Clara,</b><br>Clara, CA            |
| <b>Dubai International Airport,</b><br>Abu Dhabi, UAE                      | <b>Hollywood Casino,</b><br>Jamul, CA                       |
| <b>Northwest Florida Beaches International Airport,</b><br>Panama City, FL | <b>Aquarium Encounters,</b><br>Marathon, FL                 |
| <b>Owen Roberts International Airport,</b><br>George Town, Cayman Islands  | <b>Harrah's Resort, Valley Center,</b><br>Center, CA        |
| <b>Canada Line Train Station,</b><br>Vancouver, BC                         | <b>Smithsonian Air and Space Museum,</b><br>Chantilly, VA   |
| <b>Baltimore Washington International Airport,</b><br>Baltimore, MD        | <b>Dodger Stadium,</b><br>Los Angeles, CA                   |
| <b>Mumbai International Airport,</b><br>Mumbai, India                      | <b>Rogers Place Arena,</b><br>Edmonton, AB                  |
| <b>Denver Union Station,</b><br>Denver, CO                                 | <b>University of Oregon Basketball Arena,</b><br>Eugene, OR |
| <b>San Diego International Airport,</b><br>San Diego, CA                   | <b>Desert Diamond Casino,</b><br>Glendale, AZ               |
| <b>Mercedes Benz Stadium,</b><br>Atlanta, GA                               | <b>The Club at Ibis,</b><br>West Palm Beach, FL             |
| <b>Coors Field,</b><br>Denver, CO  | <b>Globe Life Field,</b><br>Arlington, TX                   |
| <b>Los Angeles Lakers Training Facility,</b><br>El Segundo, CA             | <b>Wind Creek Hotel and Casino,</b><br>Wetumpka, AL         |
| <b>Ferrari World Theme Park,</b><br>Abu Dhabi, U.A.E.                      | <b>Red Rock Casino,</b><br>Las Vegas, NV                    |
|  | <b>Marlins Park,</b><br>Miami, FL                           |

